



ESIS Pty Ltd

Ph 02 9481 7420 www.esis.com.au
Fax 02 9481 7267
PO Box 450, Pennant Hills NSW 2120

Smart Point-of-Care
Mounting and Mobility Solutions
for Your Entire Facility



Implement cost effective solutions while maintaining the highest standards of quality patient point-of-care. Ergotron is committed to manufacturing mount and mobility products packed with the features you need—helping you make the most of your emergency room software and systems investments.

StyleView: Everywhere Point-of-Care

**Our latest StyleView® solutions:
industry-leading carts and now
point-of-care wall mounts**



Healthy computing starts here!

Ergotron is uniquely qualified to bring the emergency room, eMAR, PACS and CPOE to the point of care. In addition to providing the necessary access your caregivers need, our products facilitate:

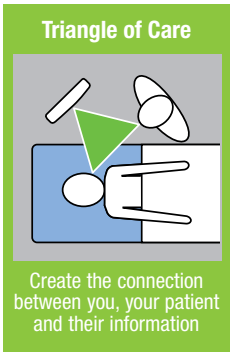

- + **COLLABORATION** with dedicated healthcare leadership and caregiving professionals worldwide
- + **CHOICE** from a broad solutions-based portfolio offering ease of motion, true ergonomic designs, and space-saving technologies
- + **CONFIGURATION** options to design workstations that fit your workflow throughout the entire facility



NEW! StyleView Vertical Lift

Compact ergonomics, extremely low profile

- ① Ergonomic negative-tilt slide-out keyboard tray (with left/right mouse tray) ensures neutral wrist position—avoid repetitive-stress injuries.
Coming soon: Vertical Lift Auto-Retracting Keyboard Kit
- ② 23 cm vertical adjustment enhances ergonomics for multiple users
- ③ Integrated cable management system can be configured on either side
- ④ Patient Room: side-to-side pan of keyboard and display promote patient-caregiver interaction
- ⑤ High Traffic Areas: total folded system depth as little as 10,2 cm



NEW! StyleView HD Combo

Wall-mount workstation with single-motion adjustment

- ① Patented CF lift-and-pivot motion technology provides premium 13 cm LCD height adjustment, portrait/landscape rotation, 30° tilt
- ② Extends/retracts LCD and keyboard up to 99 cm. Total folded system depth as little as 30,5 cm
- ③ Optional 46 cm extender arm increases range of motion for even greater reach
- ④ Clean, concealed routing of cables through expansive cable management system

NEW! StyleView VL Enclosure

Compact, secure workstation

- Keyless locking mechanism protects equipment and keeps patient data private
- Side-to-side pan of keyboard and display promote patient-caregiver interaction
- 9" (23 cm) vertical adjustment and 5" (13 cm) slide-out keyboard tray enhance ergonomics for multiple users
- Low profile and narrow wall footprint are perfect for space-constrained areas





Designed for Nurses
 Engineered for IT
 Priced for Procurement
 Certified for Safety



See StyleView in action
<http://movies.ergotron.com>



StyleView: Lean. Clean. Smart. Cart.

Increase productivity, patient safety and quality service

- ① Worksurface height adjustment for comfortable sit/stand data entry
- ② 13 cm independent monitor height adjustment. Total height range 63 cm
- ③ Ergonomic negative-tilt slide-out keyboard tray (with left/right mouse tray) ensures neutral wrist position—avoid repetitive-stress injuries
- ④ Electronic autolock drawer, programmable with keypad. Optional second drawer accessory
- ⑤ Ultra-smooth gliding casters (two locking) for easy push/pull mobility

For patient and caregiver safety, cart and power system are certified to UL 60601-1 and NFPA leakage current limits

	LCD Powered Autolock Drawer	LCD Powered	LCD Non-Powered Autolock Drawer	LCD Non-Powered	Notebook Powered Autolock Drawer	Notebook Powered	Notebook Non-Powered Autolock Drawer	Notebook Non-Powered
Europe	SV32-32053	SV32-32003	SV31-31051	SV31-31001	SV32-32054	SV32-32004	SV31-31052	SV31-31002
Ireland United Kingdom	SV32-32055	SV32-32005	SV31-31051	SV31-31001	SV32-32056	SV32-32006	SV31-31052	SV31-31002
Hong Kong Malaysia Singapore	SV32-32055	SV32-32005	SV31-31051	SV31-31001	SV32-32056	SV32-32006	SV31-31052	SV31-31002
China	SV32-32059	SV32-32009	SV31-31051	SV31-31001	SV32-32060	SV32-32010	SV31-31052	SV31-31002
Australia New Zealand	SV32-32057	SV32-32007	SV31-31051	SV31-31001	SV32-32058	SV32-32008	SV31-31052	SV31-31002
Japan	SV32-32061	SV32-32011	SV31-31051	SV31-31001	SV32-32062	SV32-32012	SV31-31052	SV31-31002
Korea	—	—	SV31-31051	SV31-31001	—	—	SV31-31052	SV31-31002
Saudi Arabia	—	—	SV31-31051	SV31-31001	—	—	SV31-31052	SV31-31002

Desk Mounts

Neo-Flex™ Combo Lift Stand



33-331-057 two-tone grey

Neo-Flex Dual Display Lift Stand



33-330-057 two-tone grey

LX Triple/Widescreen Dual Display Lift Stand



33-296-195 black

LX Dual Side-by-Side Arm



45-218-194 silver
EMEA only:
45-218-195 black

MX Desk Mount LCD Arm



45-214-026 polished aluminum

LX Desk Mount Notebook Arm



45-192-194 silver
45-192-195 black

LX Desk Mount LCD Arm



45-179-194 silver
45-179-195 black

Neo-Flex LCD Stand



33-310-060 black & silver

Wall Mounts

LX Wall Mount LCD Arm



45-180-194 silver
45-180-195 black

Neo-Flex Wall Mount Lift



60-577-195 black

Wall Mounts



TM Tilting Wall Mount
60-572-003 silver
WM Low Profile Wall Mount
60-578-003 silver

Neo-Flex Dual Monitor Wall Mount



28-514-800 grey & black
60-572-003 silver
28-513-100 grey
Slide-out keyboard tray, 10" wall track, wrist rest, mouse pad, mouse holder

StyleView Vertical Lift Patient Room



60-594-216 white

StyleView HD Combo



45-215-216 white
EMEA only: 45-215-200 black
System
45-216-216 white
EMEA only: 45-216-200 black

NEW! StyleView VL Enclosure



60-595-062 white

NEW! 200 Series Combo Arm



45-230-216 white
45-230-200 black

LX Wall Mount System



Medium CPU
28-518-194 silver
28-518-195 black
Small CPU
28-517-194 silver
28-517-195 black

Carts

Neo-Flex Mobile MediaCenter



24-190-057 LD, grey
24-191-057 VHD, grey
24-192-057 UHD, grey
Camera Shelf Kit
97-491-057
800 mm Kit
97-489

Neo-Flex Mobile WorkSpace



24-182-055 two-tone grey

Neo-Flex Laptop Mobile WorkSpace



24-186-055 two-tone grey

NEW! NF Extended Worksurface



97-483-055 two-tone grey

NEW! Neo-Flex WideView WorkSpace



Dual LCD
24-194-055 two-tone grey
Camera Shelf Kit
97-500-055
Single LCD, APAC only:
24-189-055 two-tone grey

More Ergotron web tools
<http://healthcare.ergotron.com>
<http://dare2dual.ergotron.com>
<http://blogs.ergotron.com>
<http://computingcomfort.org>
<http://assessment.ergotron.com>
<http://planner.ergotron.com>

© 2009 Ergotron, Inc. rev. 04/06/2009 870-01-012-E0 Content is subject to change without notification
Some products may not be available in some regions of the globe—visit our web site for more information

Americas Sales and Corporate Headquarters

St. Paul, MN USA
(800) 888-8458
+1-651-681-7600
www.ergotron.com
sales@ergotron.com

EMEA Sales

Amersfoort, The Netherlands
+31 33 45 45 600
www.ergotron.com
info.eu@ergotron.com

APAC Sales

Tokyo, Japan
www.ergotron.com
info.apac@ergotron.com

Worldwide OEM Sales

www.ergotron.com
info.oem@ergotron.com

ESIS Pty Ltd

Ph 02 9481 7420 www.esis.com.au
Fax 02 9481 7267
PO Box 450, Pennant Hills NSW 2120

