

## GMW115 Carbon Dioxide Transmitter for Demand Controlled Ventilation



### Features/Benefits

- Compact, wall-mounted transmitter for demand controlled ventilation
- Incorporates Vaisala CARBOCAP®, the silicon based NDIR sensor with unique internal referencing
- Advanced, single-beam, dual wavelength measurement with no moving parts
- Excellent long-term stability
- Ideal for ventilation control in all types of occupied spaces

*The Vaisala CARBOCAP® Carbon Dioxide Transmitter GMW115 is a wall-mounted CO<sub>2</sub> transmitter for demand controlled ventilation.*

The wall-mounted Vaisala CARBOCAP® Carbon Dioxide Transmitter GMW115 is a compact transmitter for measuring room carbon dioxide levels in building automation applications.

Room carbon dioxide level is an indicator for indoor air quality and human presence. It can be used to steer ventilation to introduce an adequate (but not excess) air flow based on the true need for fresh air. Demand controlled ventilation is well suited to buildings and premises where occupancy varies. Examples of such facilities are schools, offices, meeting rooms, auditoriums, and sports arenas.

The GMW115 transmitter is designed for indoor use in various demand

controlled applications. The transmitter is easy to install and needs practically no maintenance. There are two optional ranges of 0...2 000 ppm and 0...5 000 ppm to select from.

### Proven Performance with the Vaisala CARBOCAP® Sensor

The GMW115 transmitter uses Vaisala CARBOCAP® carbon dioxide sensor, a silicon-based infrared (IR) absorption sensor. The excellent long-term stability of the CARBOCAP® sensor results from its unique measurement technology. The sensor features an electrically tunable Fabry-Perot Interferometer for built-in reference measurement. The sensor not

only measures CO<sub>2</sub> absorption but also a reference, which makes it possible to compensate for potential light intensity variations and contamination and dirt accumulation in the optical path, making the sensor extremely stable over time.

CARBOCAP sensor has no need for any compensation algorithms that are used in more simple sensors to compensate for their drift. In buildings with around-the-clock occupancy (e.g. hospitals, manufacturing facilities, residential buildings, and retirement homes) the compensations based on assumed background carbon dioxide level simply do not work.

# Technical Data

## Performance

CO <sub>2</sub> -measurement range	0 ... 2000 ppm 0.....5000 ppm
Accuracy (including repeatability, non-linearity and calibration uncertainty)	±(2 % of range + 2 % of reading)
Long-term stability	± 5 % of range/5 years
Response time T90	1 min
Temperature dependence, typical	-0,35 % of reading / °C
Pressure dependence, typical	+0,15 % of reading/hPa
Warm-up time	1 min, 10 min for full specification
Product lifetime	> 10 years

## Operating Environment

Temperature	-5 ... +45 °C (23 ... 113 °F)
Humidity	0 ... 85 %RH
Pressure	700 ... 1200 hPa
Electromagnetic compatibility	Complies with EMS standard EN61326-1, Generic Environment

## Inputs and Outputs

Operating voltage	24 V (±20 %) AC/DC
Power consumption	<2 W
Outputs	4 ... 20 mA, 0 ... 10 V, RS-485, 2-wire, non-isolated

## Housing

Material:	ABS plastics
Colour:	Cyclac 233599/NCS 0502-G50Y
Fire resistance:	UL94 HB
Ingress protection:	IP30

## Dimensions

Dimensions in mm

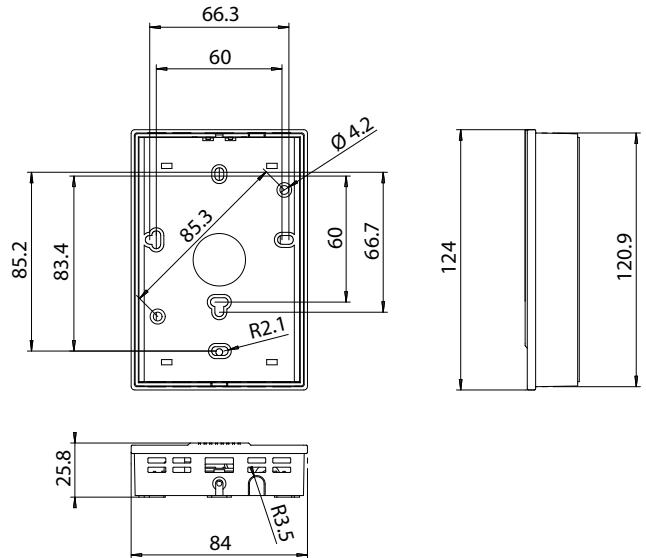

# VAISALA



**www.esis.com.au**  
Ph 02 9481 7420  
Fax 02 9481 7267  
esis.enq@esis.com.au

**ESIS**  
Industrial Electronics

Ref. B210568EN-E ©Vaisala 2012  
This material is subject to copyright protection, with all copyrights retained by Vaisala and its individual partners. All rights reserved. Any logos and/or product names are trademarks of Vaisala or its individual partners. The reproduction, transfer, distribution or storage of information contained in this brochure in any form without the prior written consent of Vaisala is strictly prohibited. All specifications — technical included — are subject to change without notice.

